



City of  
**Santa  
Monica**

# Douglas Park Playground Reconstruction

COMMUNITY MEETING NO.2

2-1-2025

LOS ANGELES COUNTY REGIONAL PARK AND OPEN SPACE DISTRICT



# Meeting Agenda

## OVERVIEW:

- Project Timeline & Funding
- Inspiration, Design Context
- Survey Results
- Design Process from Outreach

## RECOMMENDED PLAYGROUND DESIGN



# Project Timeline & Funding



# From Early Beginnings to Present Day

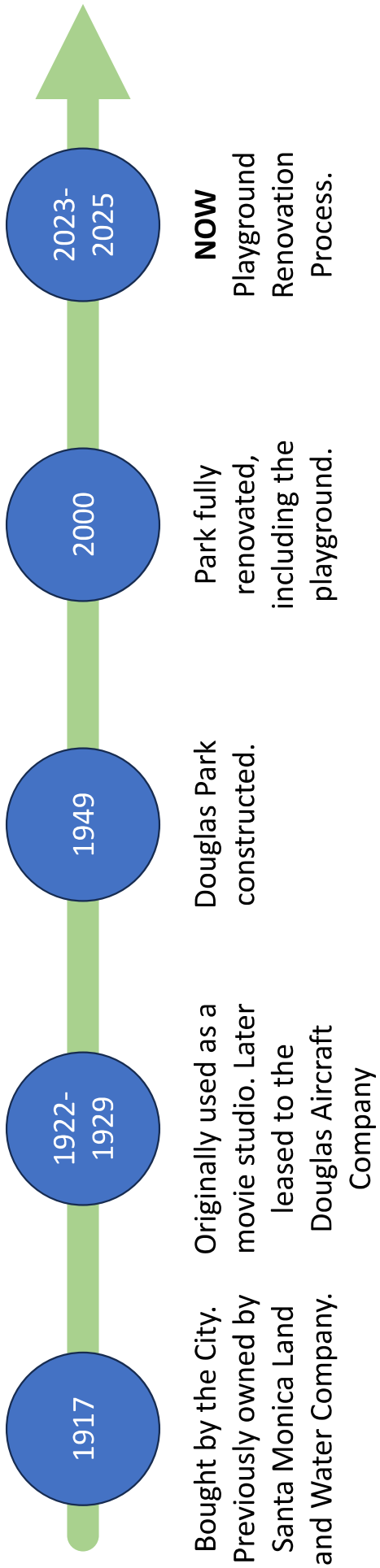

Although part of Santa Monica's Historic Resources Inventory, Douglas Park is not listed as a Landmark and the 1917 deed does not note any development restrictions.

# Project Timeline

## Opportunities for Community Input

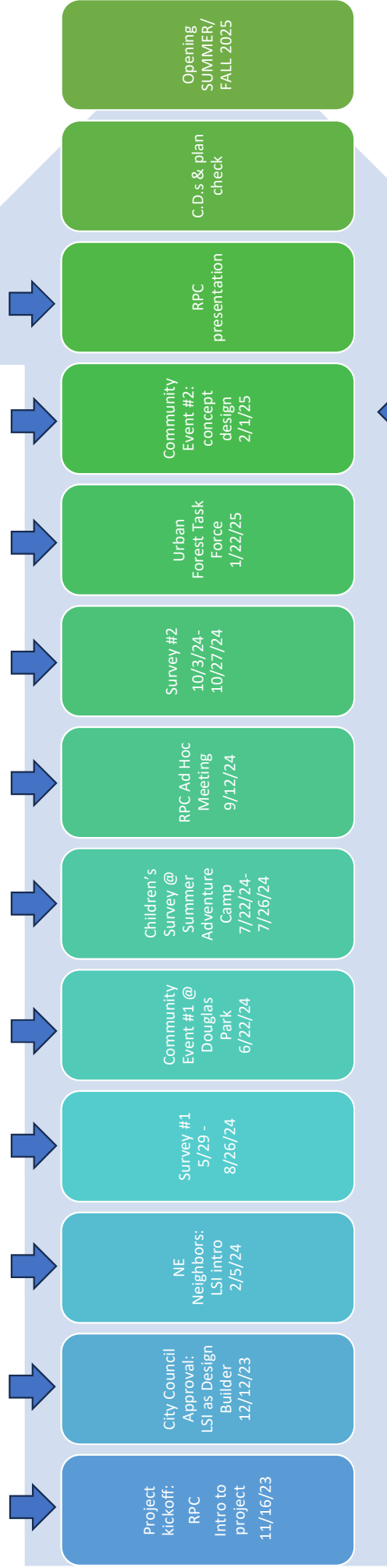

WE ARE HERE

# Where the Money Comes From

## BLENDED FUNDING SOURCES, BUT WITH LIMITATIONS ON SCOPE.

The primary funding source comes from the Los Angeles County Regional Park and Open Space District (RPOSD) Grant.

City Money	\$486,300
Grant Money	\$1,443,700
<b>Total</b>	<b>\$1,930,000</b>

## RPOSD

grant agreement:

*"This project will replace the existing playground with new universally-accessible AND inclusive play equipment, shade sails, safety surface, seating and planted areas."*



# A Path Forward for Community Design



# City Priority: Equity for All



## Council Policy: Equity for All

*"Everyone in Santa Monica must have an opportunity to thrive regardless of race, class, gender, disability or other identities."*



# Advancing Equity in Santa Monica

## Department Partnerships:

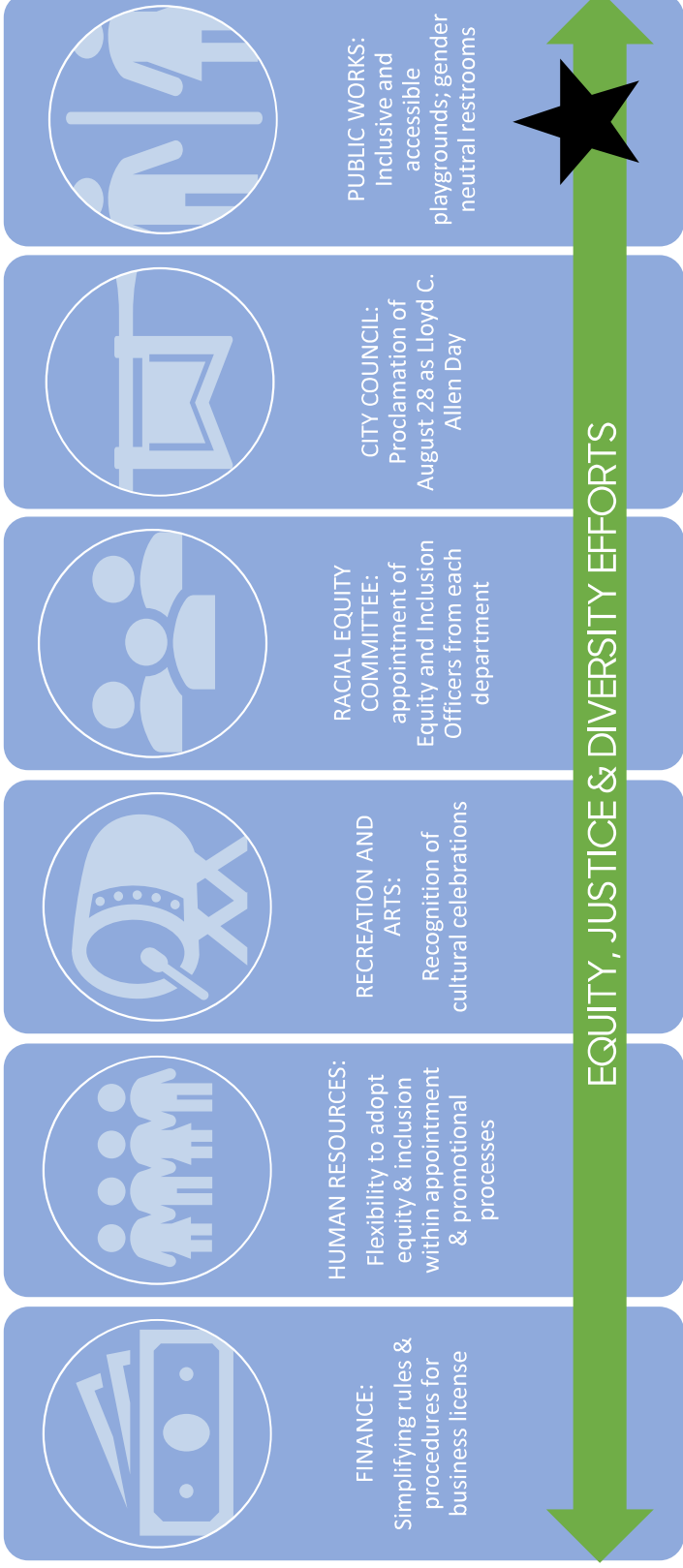

EQUITY, JUSTICE & DIVERSITY EFFORTS

# Designing for An Inclusive Community

ADA require that playgrounds be accessible for wheelchair. Inclusive playground exceeds ADA by including elements designed for children with other disabilities.

What is an inclusive playground?  
sensory-rich environment that enables all children to develop physically, socially and emotionally.

An inclusive playgrounds sends a positive message.  
Everyone is meant to be there.  
Everyone matters.  
Everyone is meant to play.

An inclusive playground isn't just for people with disabilities. It's for everyone and allowing everyone to feel welcome, vital and have fun!

# Including the Largest Minority Group: Disability

1 IN 5 AMERICANS HAVE DISABILITY.

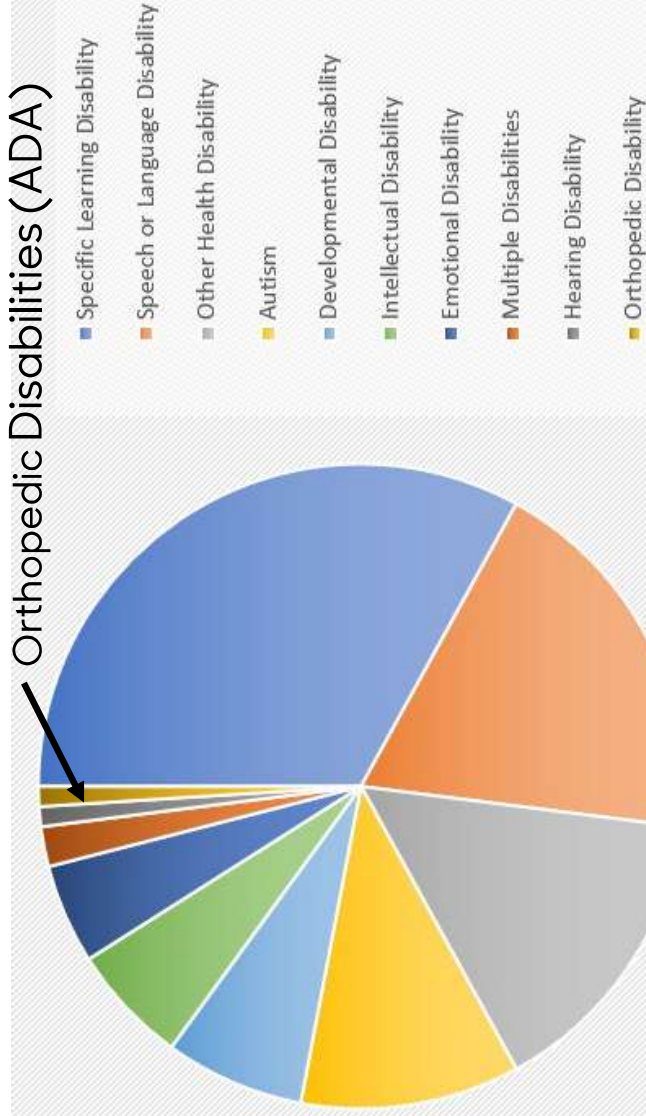

Disabilities in 14.3% of enrolled children  
National Center for Education Statistics, 2022

"Disability is the world's largest minority group and the only one anyone can join at any time"

2024 WHO

# Inclusive Playground Equipment

## VARIOUS PLAYTYPES



Auditory



Vestibular



Visual



Cognitive



Proprioceptive



Tactile



Social



Sensory (quiet)

# The Inspiration: A Playground for All

## OPPORTUNITY TO CREATE INCLUSIVE, SAFE, AND PLAYFUL EXPERIENCES

The design is inspired by:

- Community Input
  - surveys
  - community meetings
  - conversations w/ park users
- Unique Features of the Park:
  - The pond and its natural edges
  - Pathways that hug the pond edge
  - Tree canopy
  - Boulders
  - Color tones of the plant material and existing equipment
- Inclusive playground



# Ideas from the Community



# Engagement Opportunities

## COMMUNITY ENGAGEMENT

-  Project Website
-  Site Banners
-  Online and Print Surveys
-  Social Media/Newsletters
-  Community Events

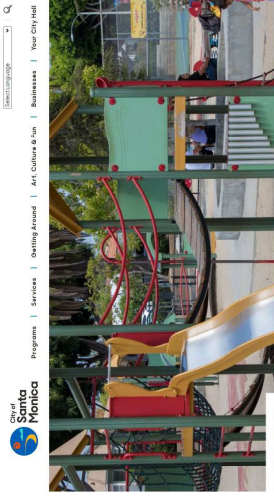

Douglas Park Playground Reconstruction Project



**SHAPING THE FUTURE OF PLAYGROUND TOGETHER**  
A project to improve and replace the playground is coming to Douglas Park. Please fill out a survey to help shape the future of the playground. Attend community outreach session to provide your input in shaping the future of the playground.

**ONLINE SURVEY - OPEN NOW!**  
By participating in the survey, residents and stakeholders have an opportunity to share their thoughts on the future of the playground. **Please complete the online survey by scanning the QR code and visiting the project website.**

**COMMUNITY MEETING #1: OUTREACH AND INFORMAL MEETING AT THE PARK**  
**Saturday, June 22, 2024, 10am-12pm**  
The City and Landscape Structures Inc. would like to meet and hear directly from residents about their thoughts on the future of the playground. Feedback from the first community workshop will be incorporated into the design of the playground, and the preferred concept design will be presented in the second and final community workshop, planned for Summer 2024.



FUNDED BY



# Community Event 1





# Community Event 1

INITIAL CONCEPTS PRESENTED TO GET THE BALL ROLLING



Concept 1

<b>LEGEND</b>	NEW CONCRETE	PLANTING AREA	RUBBER SURFACING COLOR TBD	PLAY SAND
<b>NEW</b>	1 CONCRETE WALK	2 ALL-INCLUSIVE PLAY EQUIPMENT	3 BENCH	4 SAFETY FENCING
	5 SEAT WALL	6 BRIDGE ACCESS	7 RAISED PLANTER	8 BOULDER
	9 RAMP	<b>EXISTING</b>	10 RESTROOM	11 TENNIS COURT
			12 STAIRS	13 INTERACTIVE ART PIECE
			14 RAISED PLANTER	
			<b>NEW TREES</b>	<b>EXISTING TREES</b>



Concept 2

# Surveys

2 ONLINE AND 1 PRINTED SURVEYS CONDUCTED

ONLINE SURVEY#1  
MAY 29-August 26, 2024  
404 responses



SUMMER ADVENTURE CAMP SURVEY  
JULY 22- JULY 26, 2024  
167 responses (TK-6th grade)



ONLINE SURVEY#2  
Oct 3 - Oct 27, 2024  
309 responses



# Online Survey #1

MAY 29 – AUGUST 26, 2024

404 RESPONSES

(survey opened 1 month before 1<sup>st</sup> community meeting and closed 2 months after)



# Online Survey #1

Q1: HOW DO YOU WANT THE PLAYGROUND TO LOOK?

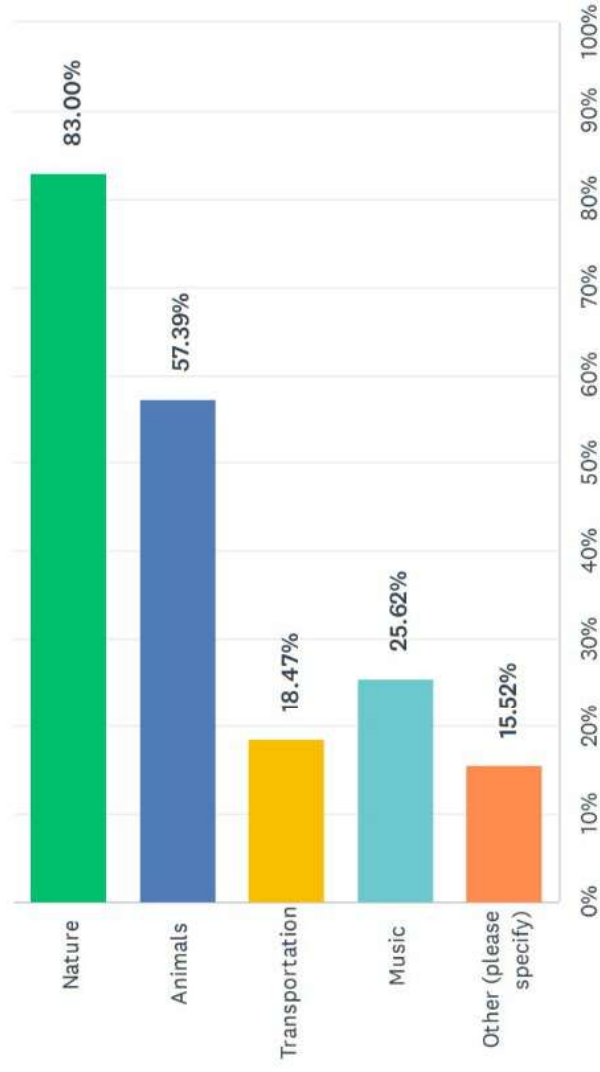

# Online Survey #1

Q2: PLEASE PICK YOUR TOP 3 PLAY ELEMENTS FOR A NEW PLAYGROUND.

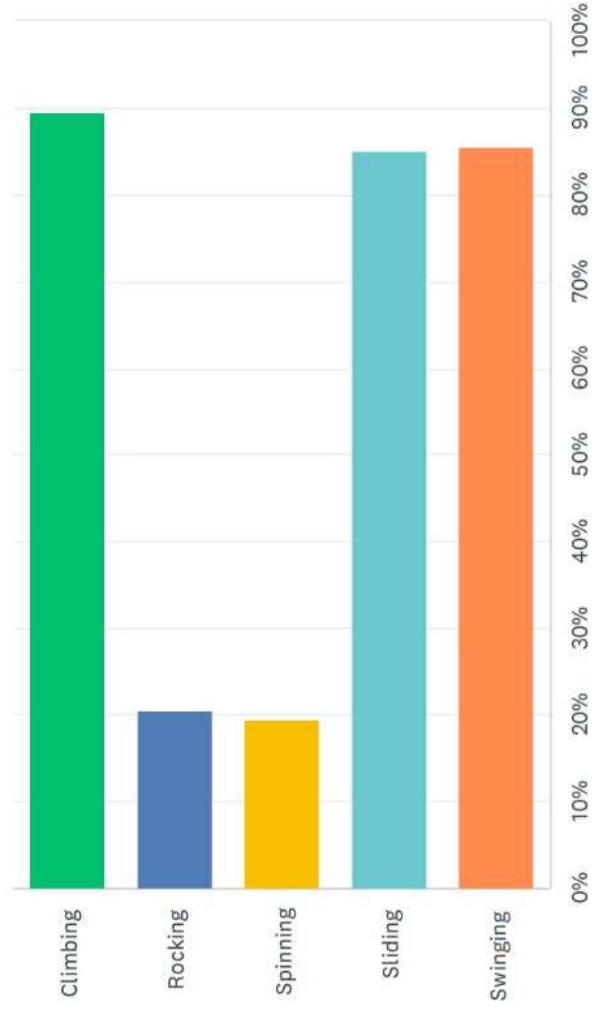

# Online Survey #1

Q3: HOW MUCH CHALLENGE DO YOU WANT TO INCORPORATE INTO THE PLAYGROUND?

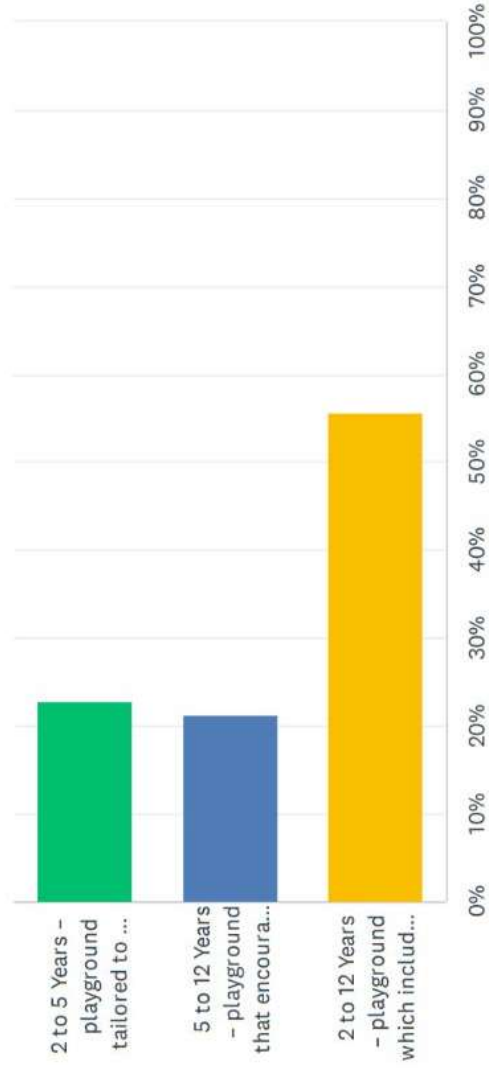

# Online Survey #1

## Q4: WHAT DO YOU LIKE ABOUT THE CURENT PLAYGROUND?

- 30%: Varieties of options for different age groups
- 20%: Sand
- 15%: Trees and shade
- 13%: Security and fencing
- 8%: Site lines & seats for parents
- 4%: Nothing and need renovation
- 3%: Art tables
- 1%: Not plastic
- 1%: Integration of wood
- 1%: Keep existing with minor upgrades

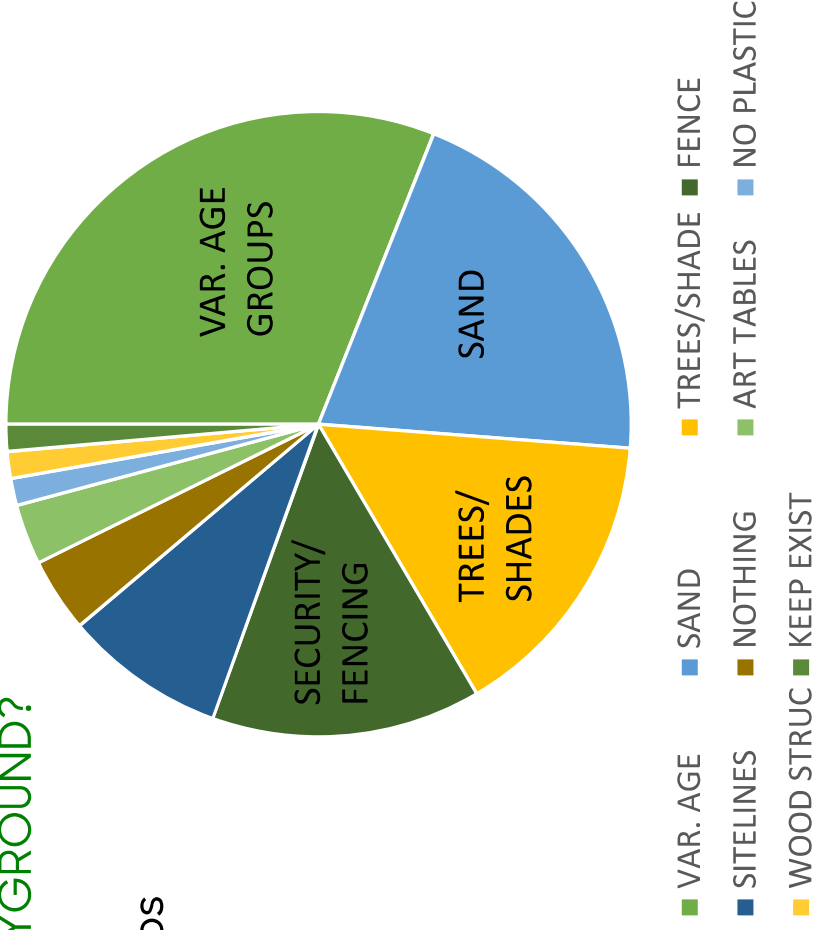

# Online Survey #1

## Q5: WHAT WOULD YOU IMPROVE UPON FOR THE CURRENT PLAYGROUND?

- 30%: Less or no sand
- 17%: More shade and green space
- 16%: New equipment
- 7%: More equipment for older children
- 7%: More rubber surfacing
- 6%: No splintering wood
- 5%: More like Marine Park
- 4%: Less exposed metal (too hot in summer)
- 4%: Cleanliness
- 3%: Keep existing with minor upgrades
- 1%: More equipment for younger children

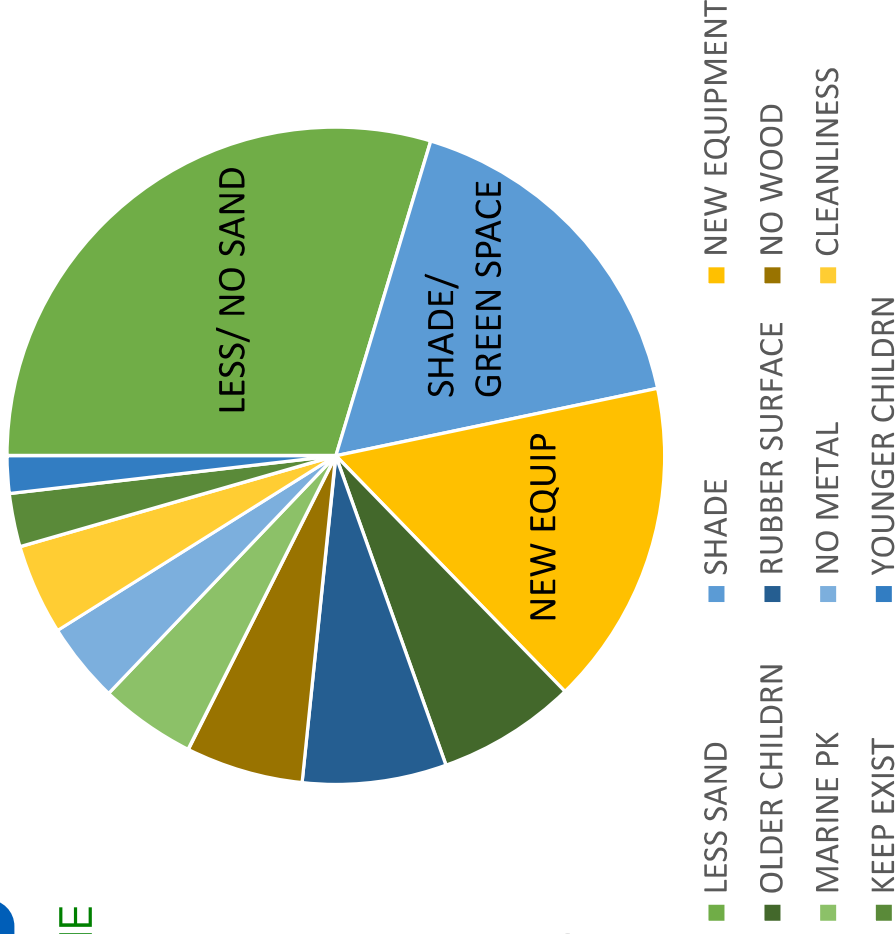



# Online Survey

## Q6: WHAT ZIP CODE DO YOU LIVE IN?

- 56%: 90403 (Douglas Park Zip Code)
- 20%: 90404
- 10%: 90402
- 10%: Adjacent City of LA, etc.

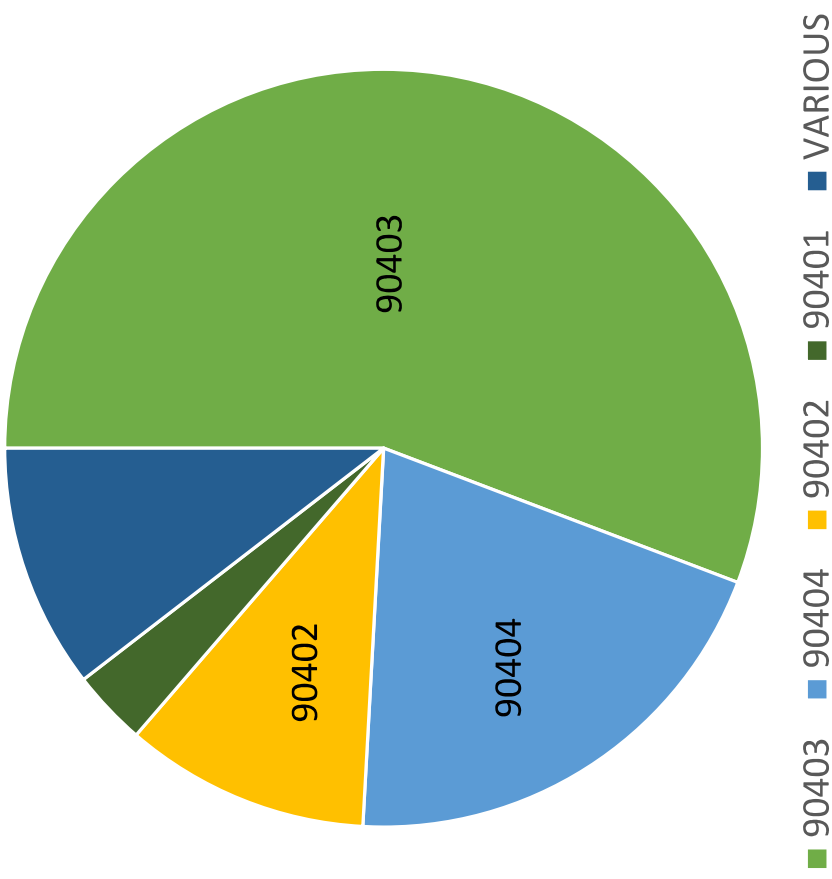
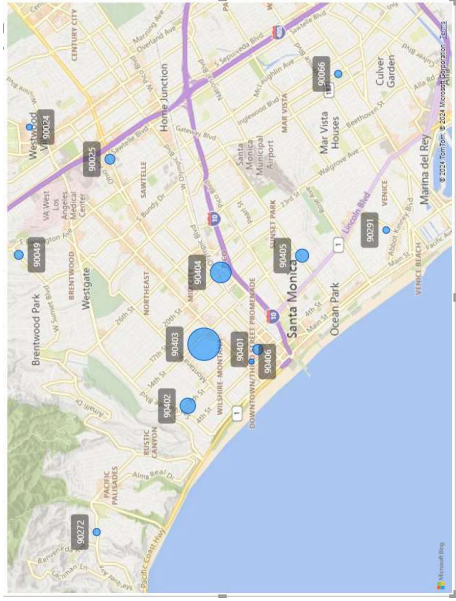

# Camp Survey

JULY 22- JULY 26, 2024  
TK - 6<sup>TH</sup> GRADERS  
SUMMER ADVENTURE CAMP  
@ ROOSEVELT ELEMENTARY SCHOOL  
(ask what the children want)



# Camp Survey

Camp @ Roosevelt Elementary School  
(2 miles away from Douglas Park)

450 surveys  
167 responses (37% participation)

#### Douglas Park Playground Reconstruction Project:

Douglas Park Playground will be renovated! The City would like to hear from the children - who will use the playground daily. Please ask your child(ren) to select their favorite pieces from the existing playground to help inspire the renovation.

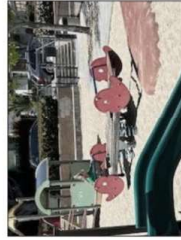

Project Funded by:  
LOS ANGELES COUNTY REGIONAL PARK AND OPEN SPACE DISTRICT

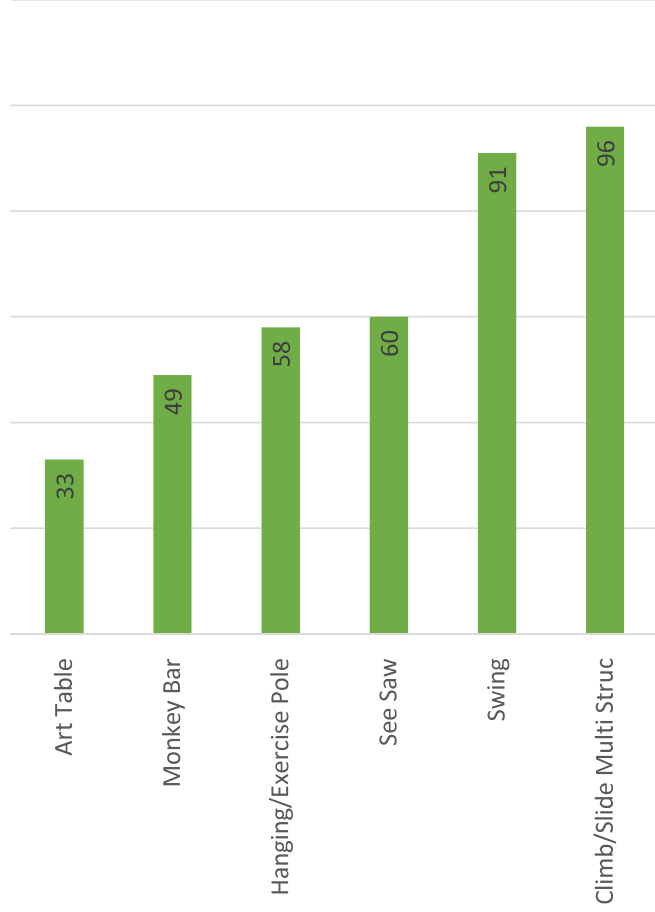

# Online Survey #2

OCT 3 – OCT 27, 2024

309 RESPONSES

(more specific design questions)



# Online Survey #2

Q1: Please select your zipcode:

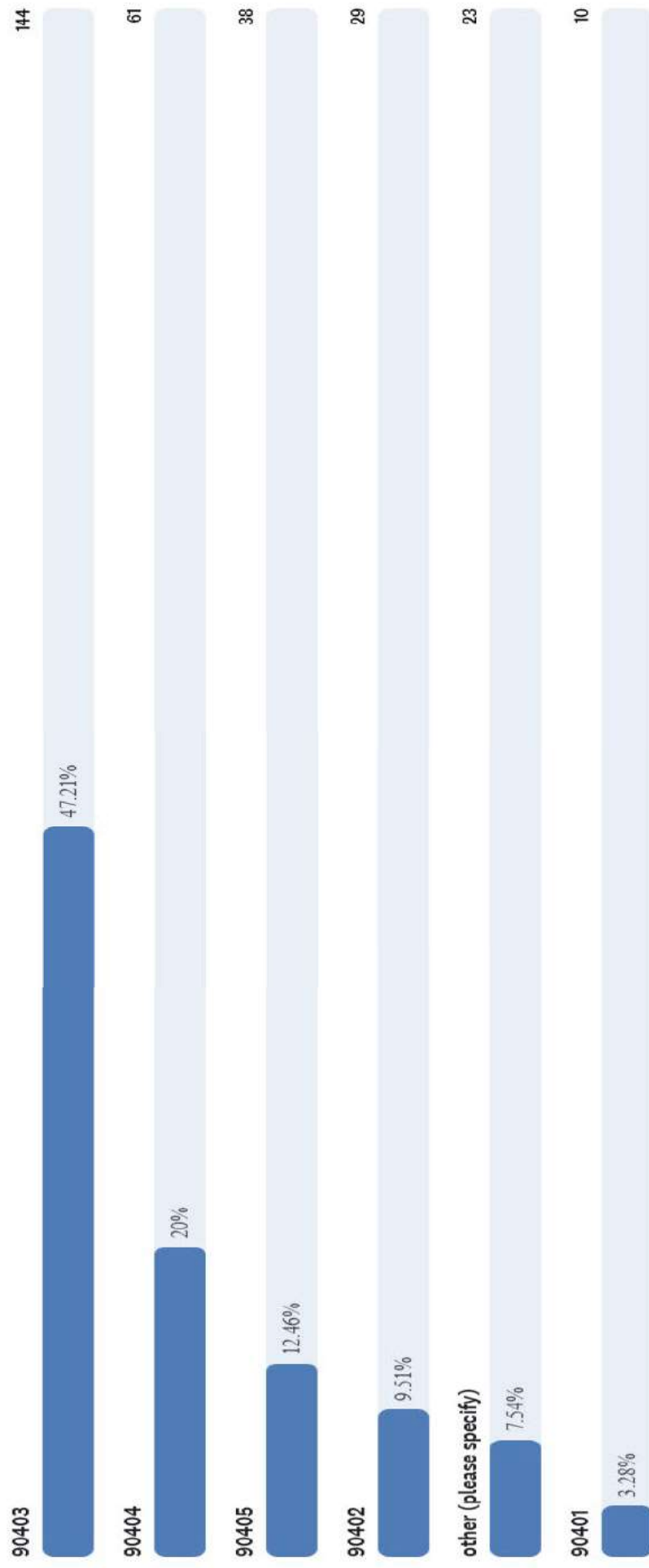

# Online Survey #2

Q2: "Nature" was the theme that resonated most with outreach participants. Please select the composition that resonates most with you.

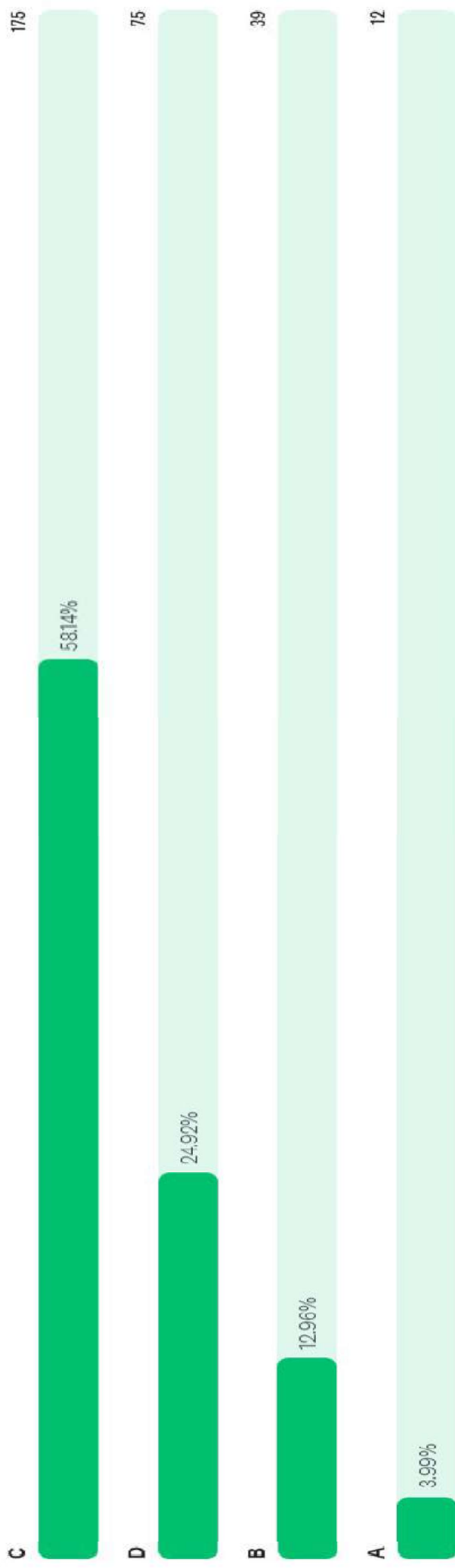

# Online Survey #2

Q3: Considering "nature" resonated most with participants, which color palette resonates most with you?

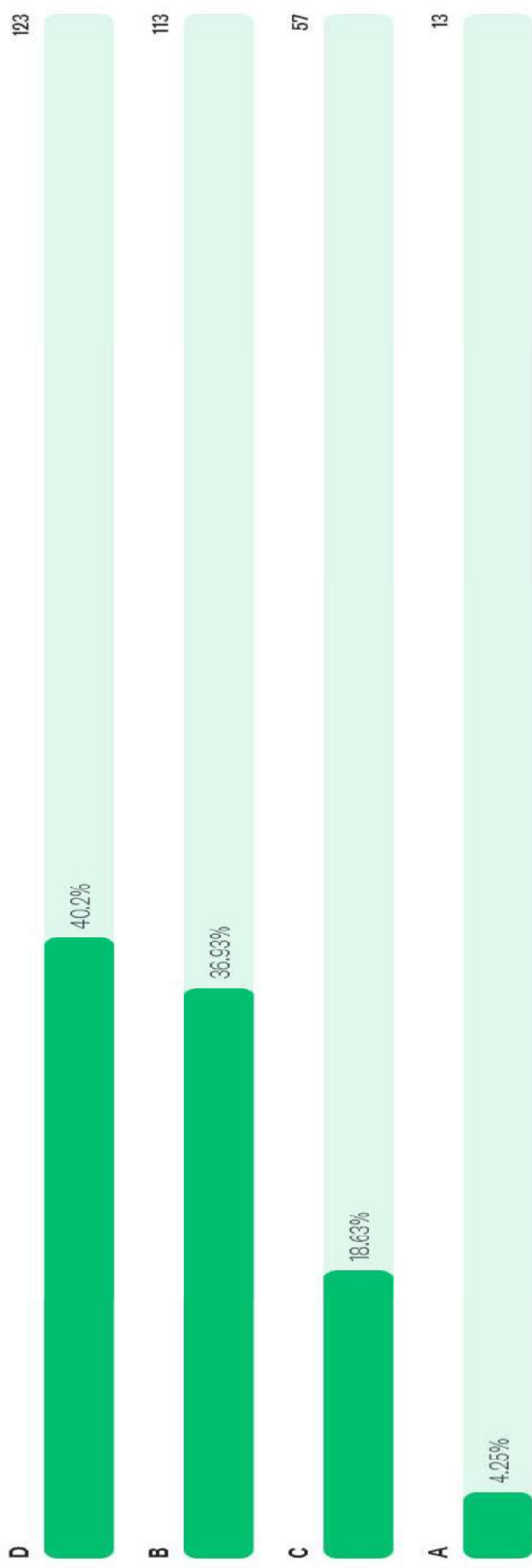

# Online Survey #2

Q4: "Slides" was one of the top 3 favorite play opportunities that exist within the current playground. What slide opportunity resonates most with you?

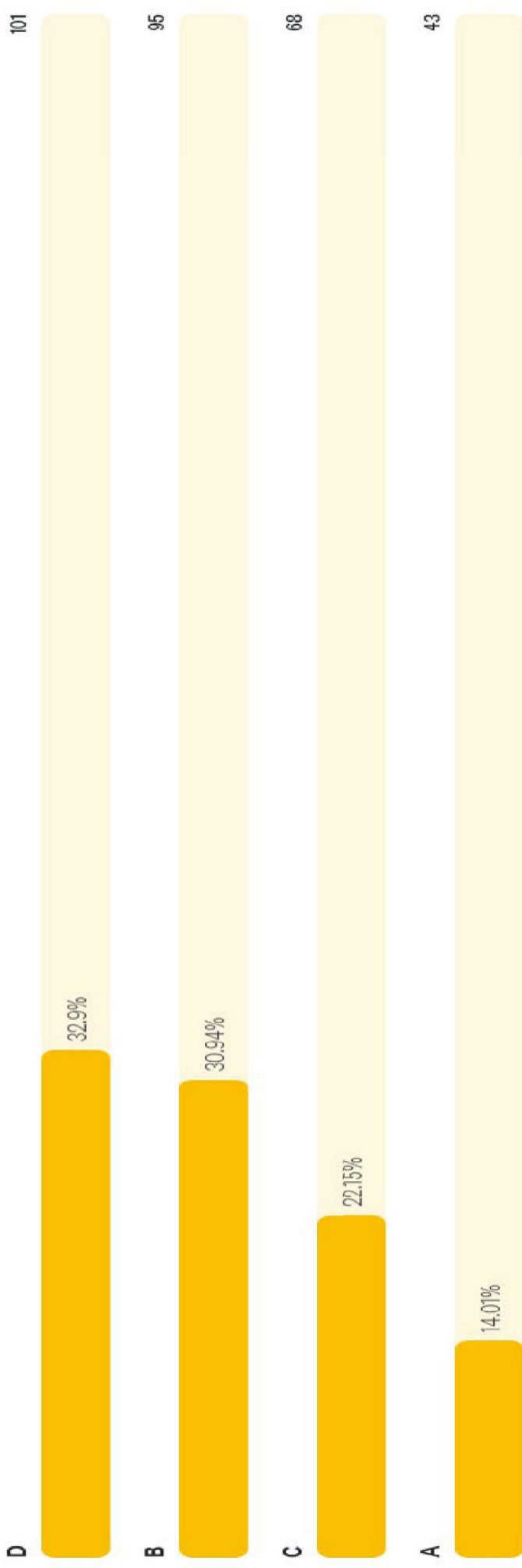



# Online Survey #2

Q5: "Climbing" was one of the top 3 favorite play opportunities that exist within the current playground. What climbing opportunity resonates most with you?



# Online Survey #2

Q6: "Swings" was one of the top 3 favorite play opportunities that exist within the current playground. What swing opportunity resonates most with you?

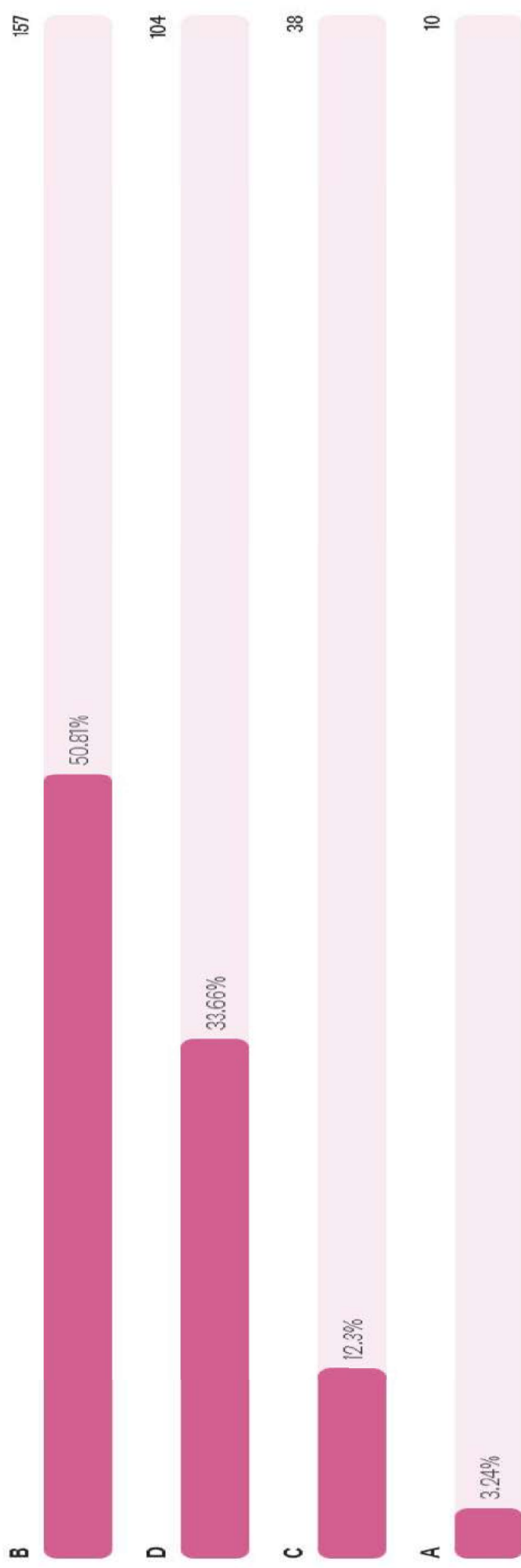

# Online Survey #2

Q7: While "sand" is an existing playground feature appreciated by many, "no/limited amount of sand" was top of the improvement asked by the community. The city will have dedicated area for sand. Which option of sand area resonates most with you?

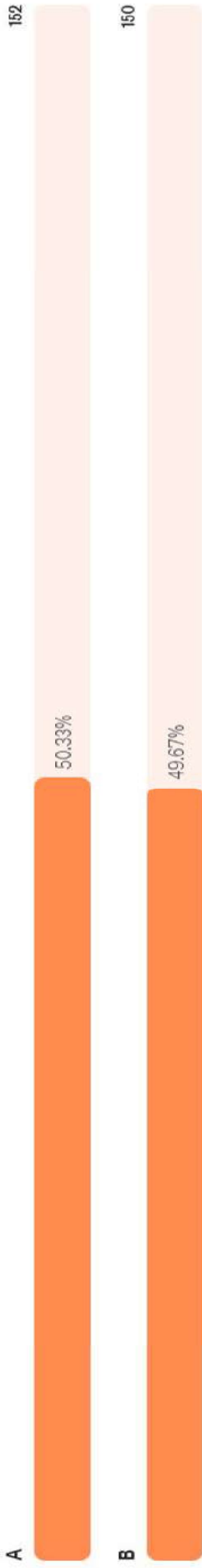

# What We Heard

## RESULTS OF SURVEYS AND COMMUNITY EVENTS



Adults asked us to:

- Study the surfacing material
- Study the type of equipment and age range
- Maintain existing trees
- Gather input from children
- Preserve existing artwork

Children were most interested in:

- Climbing/ slide/multi structure
- Swings

# Design Studies



# Design Elements Considered

THESE ELEMENTS HAVE BEEN REVIEWED WITH CITY STAFF AND RPC AD HOC



Playground Equipment



Surface Material

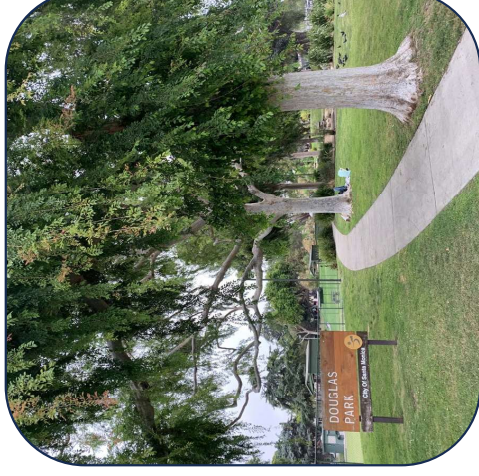

Trees



Artwork Installations

# Existing Equipment

EXISTING EQUIPMENT IS NEARING THE END OF ITS LIFESPAN AND DIFFICULT TO MAINTAIN.

Installed 24 years ago, the equipment is approaching the end of its lifespan.

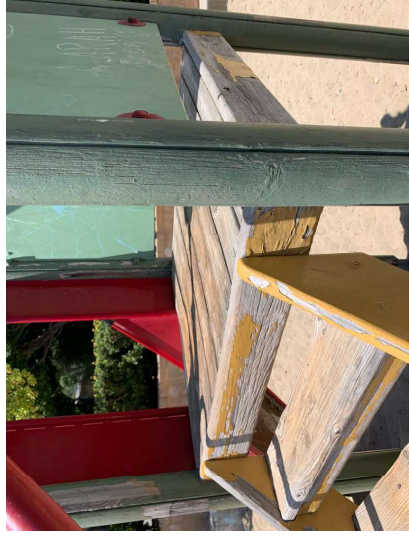

# Equipment Evaluation

## PROPOSED EQUIPMENT:

- Universally accessible
- Domestically-sourced
- Lead-time within grant timeline
- Readily available replacement parts
  - Low maintenance
- Maintenance (5 years) eligible for grant funding
  - High longevity
- Minor installation
- Low upfront cost
- Low lifetime cost
- Recycled content





# Equipment Evaluation

## EXISTING EQUIPMENT:

- Universally accessible
- Domestically-sourced
- Lead-time within grant timeline
- Readily available replacement parts

- Low maintenance
- Maintenance (5 years) eligible for grant funding
  - High longevity ●
  - Minor installation ●
  - Low upfront cost ●
  - Low lifetime cost ●
  - Recycled content ●



# Equipment Recommendation

## PROPOSED VS EXISTING

- Universally accessible
- Domestically-sourced
- Lead-time within grant timeline
- Readily available replacement parts
  - Low maintenance
- Maintenance (5 years) eligible for grant funding
  - High longevity
  - Minor installation
  - Low upfront cost
  - Low lifetime cost
  - Recycled content

Proposed  
Existing



# Existing Equipment Zones

We've observed existing Douglas Park Playground provides approximately:

- 50% (2-5)
- 50% (5-12)

NOTE:  
equipment serving both age groups (2-12 are evenly divided between the two age groups)

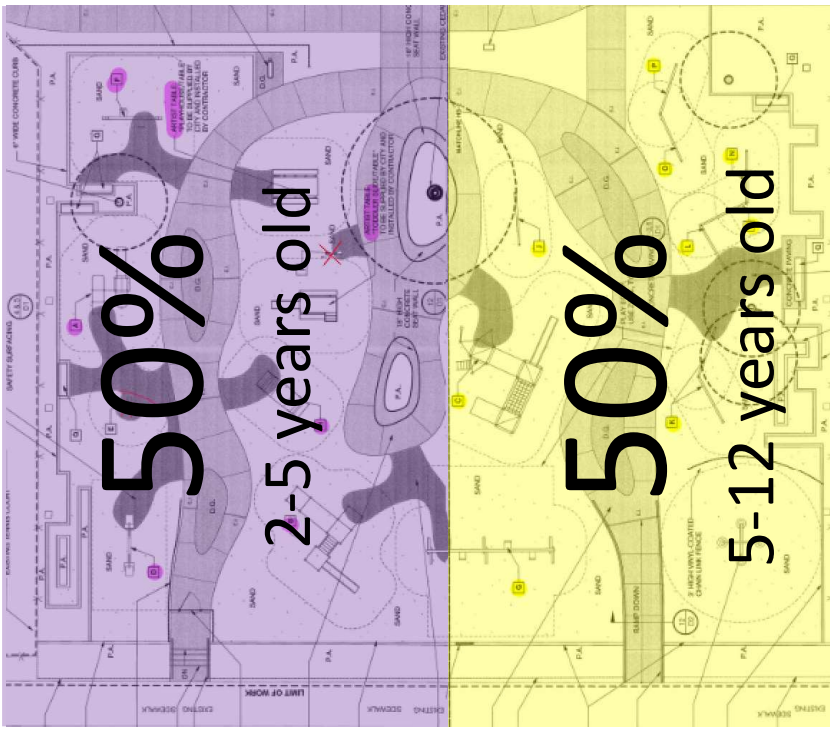

Existing User Group Distribution

# Surface Material

## THREE OPTIONS REVIEWED



Resilient Surfacing



Engineered Wood



Sand

# Surface Material - Resilient Surfacing

- Universally accessible
- Low maintenance
  - High longevity
  - Easy installation
- Low upfront cost
- Low lifetime cost
- Consistent fall zone (distance)
- Consistent fall zone (depth)
  - Good impact absorption
- Safety (sharp objects/debris/waste)
  - Recycled content
- Compatibility with resilient surfacing



# Surface Material - Engineered Wood Fiber

- Universally accessible ● \*\*
- Low maintenance
  - High longevity
- Easy installation ●
- Low upfront cost ●
- Low lifetime cost
- Consistent fall zone (distance)
  - Consistent fall zone (depth)
- Good impact absorption
- Safety (sharp objects/debris/waste) ●
- Recycled content ●
- Compatibility with resilient surfacing ●



\*\*though considered accessible, it is difficult to maintain accessibility due to its constant shifting and moving nature of the material

# Surface Material - Sand

- Universally accessible
- Low maintenance
  - High longevity ●
  - Easy installation ●
  - Low upfront cost ●
  - Low lifetime cost ●
- Consistent fall zone (distance)
- Consistent fall zone (depth)
  - Good impact absorption ●
- Safety (sharp objects/debris/waste)
  - Recycled content ●
- Compatibility with resilient surfacing



# Surface Material – Recommendation

- Universally accessible ●
- Low maintenance ●
- High longevity ●
- Easy installation ● ●
- Low upfront cost ● ●
- Low lifetime cost ● ●
- Consistent fall zone (distance) ● ●
- Consistent fall zone (depth) ● ●
- Good impact absorption ● ●
- Safety (sharp objects/debris/waste) ● ●
- Recycled content ● ●
- Compatibility with resilient surfacing ● ●

Resilient surfacing  
Engineered wood fiber  
Sand





# Existing Trees

KEEP AS MANY TREES AS POSSIBLE

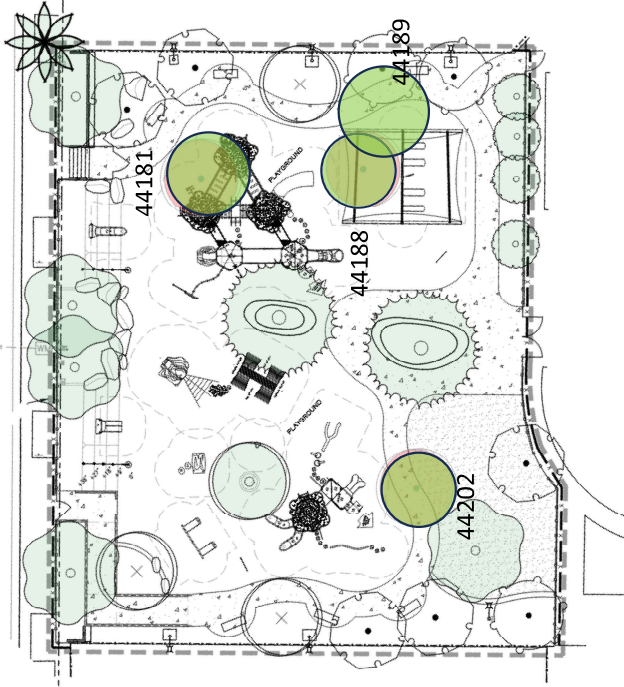

TREE RESTITUTION CALC

Site ID	DBH	Goal	Trees	\$
44189	12	removal	7.562564507	\$6,404.59
44188	7	box	2.227990317	\$1,889.34
44181	7	box	2.227990317	\$1,889.34
44202	9	box	3.683004401	\$3,123.19

EXISTING PLAYGROUND TREES: 16  
 EXISTING TREES REMOVED : 1  
 EXISTING TREES TRANSPLANTED: 3  
 NEW TREES PROPOSED: 8  
 NEW PLAYGROUND TREE TOTAL: 23

- TREE REMOVAL CRITERIA:**
- REQUIRES EXTENSIVE ROOT PRUNING RESULTING IN THE SEVERE REDUCTION OF ITS CAPACITY TO SUPPORT ITSELF, THEREBY CREATING A POTENTIAL SAFETY HAZARD
  - NOT A GOOD CANDIDATE FOR RELOCATION

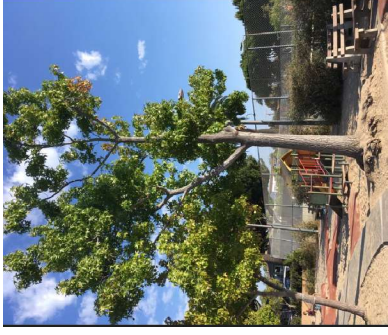

REMOVE

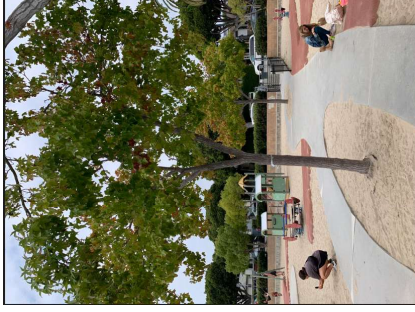

TRANSPLANT

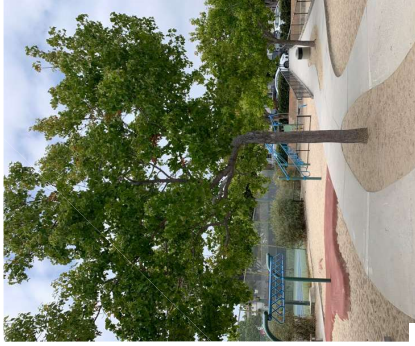

# New Trees

## REDBUD & WILLOW

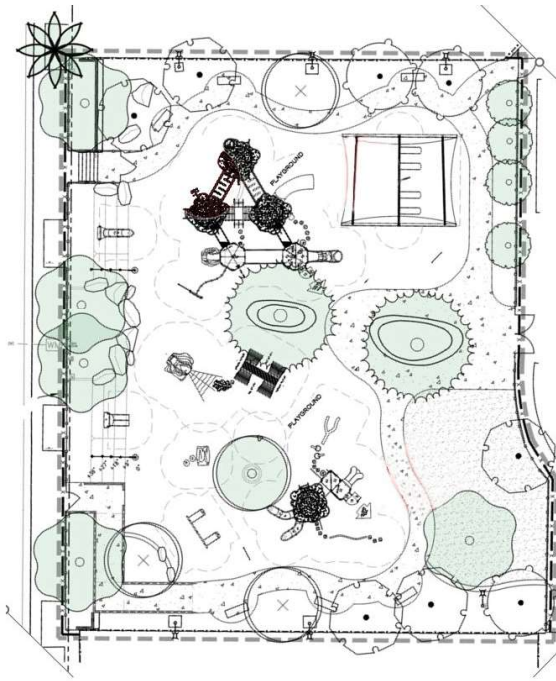

EXISTING PLAYGROUND TREES: 16  
 EXISTING TREES REMOVED : 1  
 EXISTING TREES TRANSPLANTED: 3  
 NEW TREES PROPOSED: 8  
 NEW PLAYGROUND TREE TOTAL: 23

### PLANT SCHEDULE

SYMBOL	QTY.	BOTANICAL / COMMON NAME	CONTAINER
	1	LIQUIDAMBAR STYRACIFLUA ROTTUNDOLOBA / ROUNDLOBED SWEET GUM	EXISTING TO REMAIN
	1	LIQUIDAMBAR STYRACIFLUA ROTTUNDOLOBA / ROUNDLOBED SWEET GUM	EXISTING TO REMAIN
	3	LIQUIDAMBAR STYRACIFLUA ROTTUNDOLOBA / ROUNDLOBED SWEET GUM	TRANSPLANTED
	5	CEIJERA PARVIFLORA / AUSTRALIAN WILLOW	24" BOX
	3	CERCIS CANADENSIS "FOREST PANSY" / FOREST PANSY EASTERN REDBUD	24" BOX
	4	ARBUTUS X "MARINA" / MARINA STRAWBERRY TREE	EXISTING TO REMAIN
	2	CEURUS ATLANTICA / ATLAS CEDAR	EXISTING TO REMAIN
	5	CINNAMOMUM CAMPHORA / CAMPHOR TREE	EXISTING TO REMAIN
	1	LIQUIDAMBAR STYRACIFLUA ROTTUNDOLOBA / ROUNDLOBED SWEET GUM	EXISTING TO REMAIN
	1	PHOENIX CANARIENSIS / CANARY ISLAND DATE PALM	EXISTING TO REMAIN

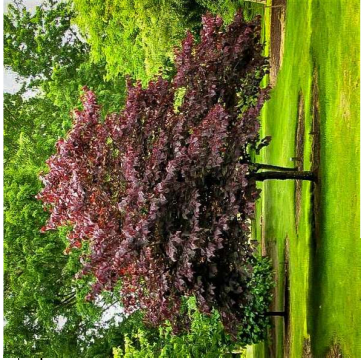

Cercis canadensis "Forest Pansy Redbud" DECIDUOUS



Geijera parviflora "Australian Willow" EVERGREEN

# Existing Artwork

"TABLES OF CONTENT": BY ALLAN AND ELLEN WEXLER

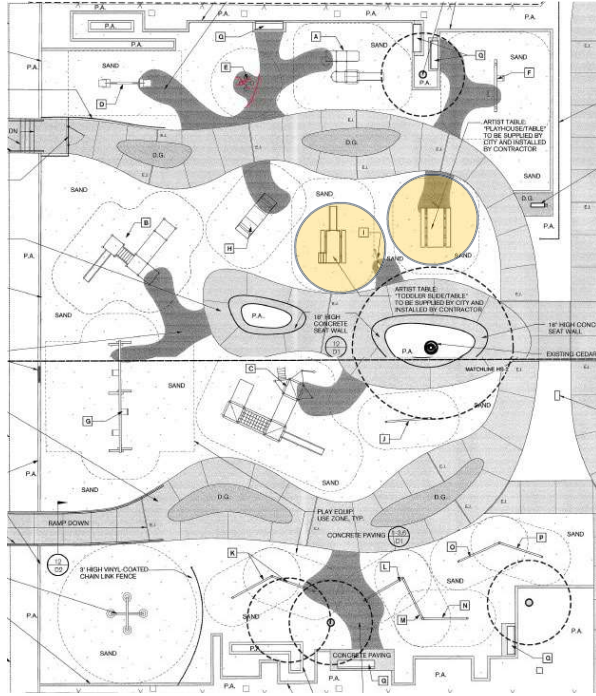

"Toddler Slide Table"



"Play House Table"



"Toddler Slide Table"

# Proposed Artwork

CALIFORNIA AVE.

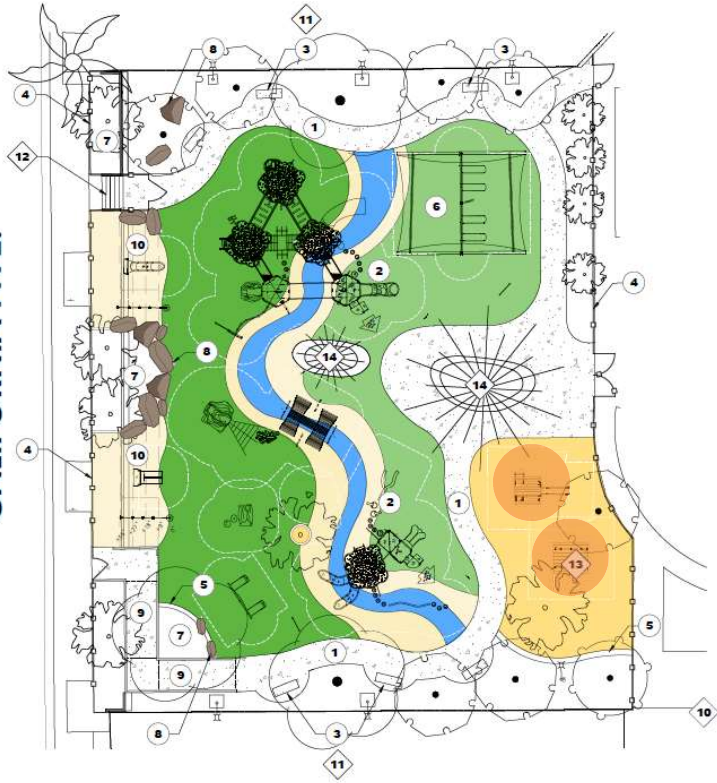

1.75"X.75" WOOD  
ADDITION ALONG  
EXISTING TOP RAIL,  
TYP.



ATTACH HANDHOLDS BOTH  
SIDES TO ASSIST USERS FROM  
STANDING TO SITTING  
POSITION

PROPOSED



PROPOSED

SIDING TO BE RESTORED IN  
MATCHING MAHOGANY, TYP.  
(SHOWN IN LIGHTER COLOR)

# Recommendations



## SURFACING

- Resilient surfacing with independent sand area
- Some concrete paths

## EQUIPMENT

- "Inclusive" LSI equipment w/ ability to maintain eligibility for continued grant funding
- targeted even ratio for toddler and school aged children

## EXISTING ARTWORK

- Keep both artwork in the playground sand area
- Staff to continue to coordinate w/ artist & Arts Commission

## TREES

- Maintain (e) trees as much as possible & relocate if necessary.
- Plant new trees
- Continue to coordinate w/ Urban Forest Task Force and Public Landscape



# Concept Design

PROPOSED

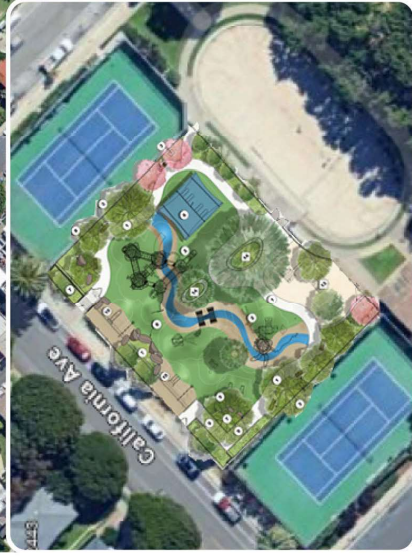

EXISTING

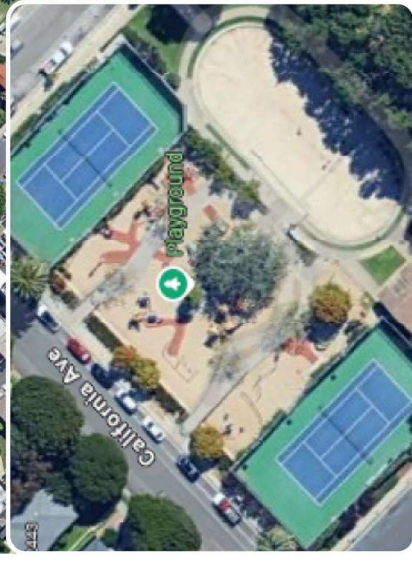



**LEGEND**

- NEW CONCRETE
- PLANTING AREA
- RUBBER SURFACING
- PLAY SAND : 1,545 SF
- NEW PLAY AREA
- TOTAL : 10,645 SF

**NEW**

- 1 CONCRETE WALK
- 2 ALL-INCLUSIVE PLAY EQUIPMENT
- 3 BENCH
- 4 SAFETY FENCING
- 5 SEAT WALL
- 6 SHADE SAIL OVER SWINGS
- 7 RAISED PLANTER
- 8 BOULDER
- 9 RAMP
- 10 PLAY HILL

**EXISTING**

- 10 RESTROOM
- 11 TENNIS COURT
- 12 STAIRS
- 13 INTERACTIVE ART PIECE
- 14 RAISED PLANTER

**NEW TREES**

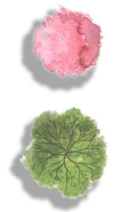

**EXISTING TREES**



Project Funded by:  
LOS ANGELES COUNTY REGIONAL PARK AND OPEN SPACE DISTRICT

City of Santa Monica **Douglas Park** Concept Plan - Option 4





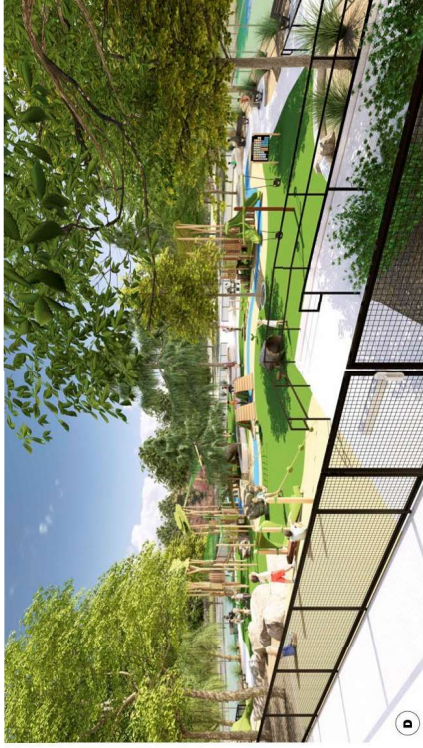

Project Funded by:  
LOS ANGELES COUNTY REGIONAL PARK AND OPEN SPACE DISTRICT



# City of Santa Monica Douglas Park Concept Renderings - Option 4



April 2025

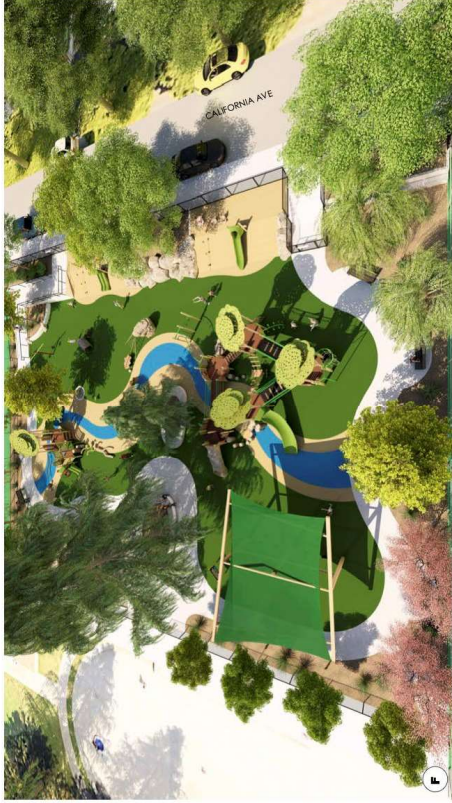

Project Funded by:  
LOS ANGELES COUNTY REGIONAL PARK AND OPEN SPACE DISTRICT



# City of Santa Monica Douglas Park Concept Renderings - Option 4



February 8am



February 12 pm



February 4 pm



June 8am



June 12pm



June 4 pm

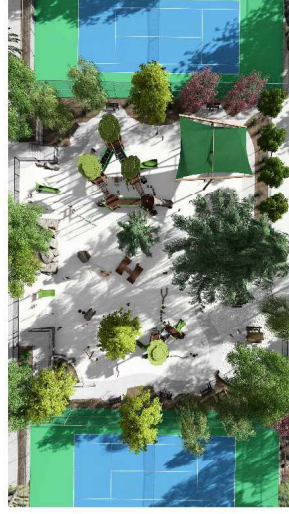

October 8am



October 12 pm



October 4 pm



# City of Santa Monica Douglas Park Shade Study

Project Funded by:  
LOS ANGELES COUNTY REGIONAL PARK AND OPEN SPACE DISTRICT



















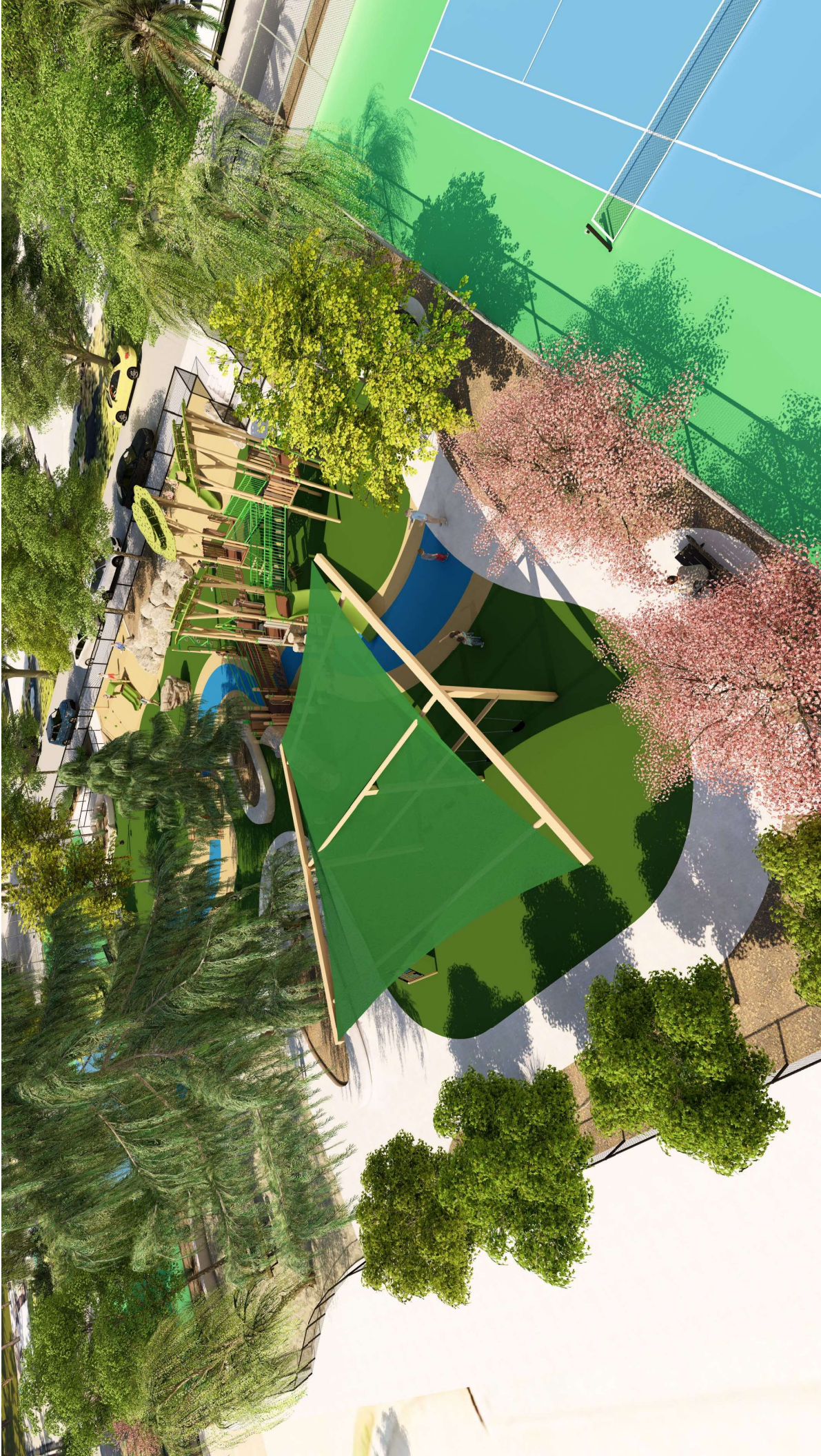





horizontal climber

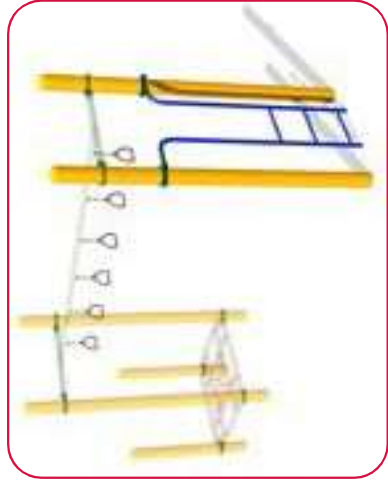

slides



Vertical Climbing

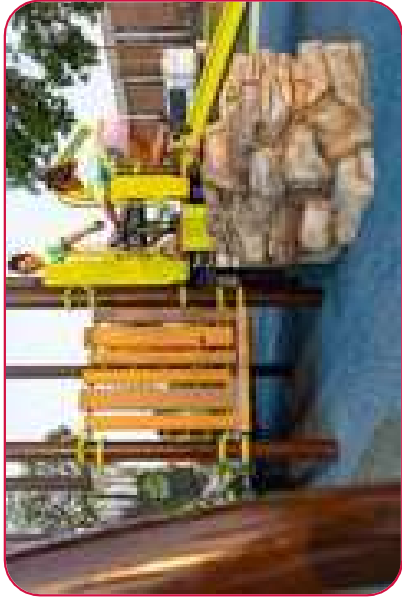

Imagination/Sensory





Motion







City of  
**Santa  
Monica**

**Douglas Park Playground  
Reconstruction**

Thank you

