



# NOTICE

## UPDATED FOR OFF-RAMP AND ON-RAMP CLOSURES

### Temporary Sidewalk Closure and Reduced Lanes

### 4<sup>th</sup> Street between Colorado Ave and Olympic Dr-Blvd

**Work Dates:** Monday June 10, 2024 - Thursday June 13, 2024

**Work Hours:** Mon-Thursday 9am to 4pm

**Location:** 4<sup>th</sup> Street between Colorado Ave and Olympic Dr-Blvd (see the map below)

Dear Neighbors:

The City of Santa Monica has contracted with Access Pacific, Inc., for the 4<sup>th</sup> Street Enhancements Project Phase II. As part of the improvements, sidewalk repairs will be performed on 4<sup>th</sup> Street between Colorado Ave and Olympic Dr-Blvd. in the northbound and southbound direction. Work will begin on Monday, June 10, 2024, and last approximately until Thursday June 13, 2024. During this time, there will be periodic single lane closures of Eastbound I-10 On-Ramp/Olympic Dr-Blvd, Northbound 4<sup>th</sup> Street at SE corner of I-10 Off Ramp, and 4<sup>th</sup> Street Southbound Left Turn Lane at I-10 On-Ramp. The traffic lanes will be reduced, and one side of the sidewalk will be closed at a time due to sidewalk repairs for the project.

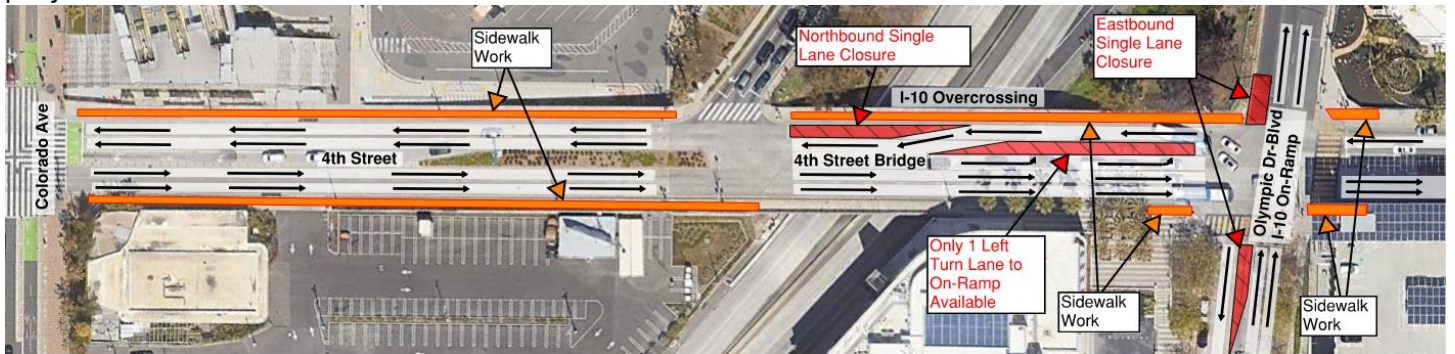

#### Construction Period:

All work will take place during daytime between the hours of 9am to 4pm, Monday through Thursday. Please note that the start and completion time/date of construction may be delayed due to unforeseen conditions and weather.

For most up to date work schedule for each phase, please refer to the project website,

<https://www.santamonica.gov/civil-engineering-projects/4th-street-enhancements-project-phase-ii>

#### Traffic Closures:

- Driveways, businesses, and Civic Center Parking Structure will remain accessible at all times.
- Sidewalk pedestrian access will be closed on one side of 4<sup>th</sup> Street at a time and only sidewalk on the opposite side of the street will be open along 4<sup>th</sup> Street.
- One lane of traffic on Northbound 4<sup>th</sup> Street will be maintained at all times.
- Only one left-turn lane will be available on Southbound 4<sup>th</sup> Street for I-10 On-Ramp with Single Lane Closure on I-10 On-Ramp/ Olympic Dr-Blvd

For project inquiries contact:

**Gene Higginbotham**  
Public Works Inspector  
(310) 754-5191

[Gene.Higginbotham@psomas.com](mailto:Gene.Higginbotham@psomas.com)

**Kyle Troka**  
Construction Manager  
(815) 474-9486

[Kyle.Troka@psomas.com](mailto:Kyle.Troka@psomas.com)



@santamonicacity



@cityofsantamonica



@cityofsantamonica